



WORLD CUP LOUNGE WEST | TE IPU O TE AO WĒTA

L4, SAMSUNG SOUTH STAND

Reimers Ave, Kingsland | Gate G

ABOUT THE VENUE

Our most versatile and popular space. Thanks to the movable walls, the World Cup Lounge can be split in half, with the west end of the lounge accommodating smaller groups. There is natural lighting from both sides of the stand and private bar facilities.

The balcony is the perfect spot for breaks, networking and fresh air overlooking New Zealand's National Stadium.

Pack in is from South Stand service lift, accessible through Gate Q.

AUDIO VISUAL

The lounge has quality installed equipment and can easily be supplemented to bring your event to life by our in-house suppliers Vidcom.

Installed in the lounge are;

- Two 10,000 lumen laser projectors and 140inch screens suiting two room orientations
- Overhead four speaker sound system
- Overhead stage wash lighting
- Eight overhead moving lights
- Installed TVs on the pillars and behind the bars

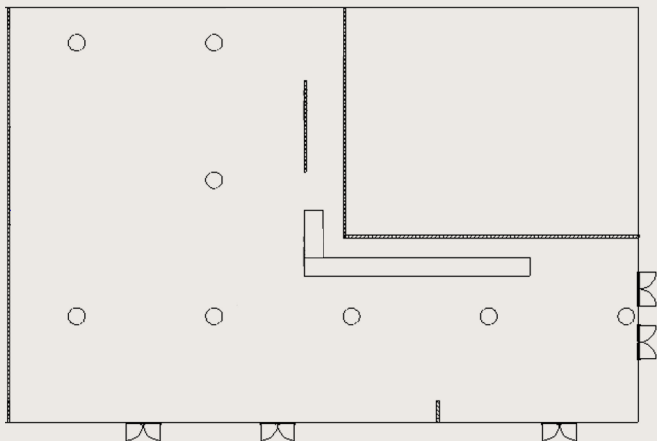

NEW ZEALAND'S NATIONAL STADIUM

BANQUET

220 guests



THEATRE STYLE

220 guests



CABARET

136 guests



COCKTAIL

475 guests



CEILING HEIGHTS

From
2,700 - 3,600 mm

FLOOR SPACE

553 sqm +
foyers & balcony