



AOTEAROA ROOM

L3, UNIVERSITY OF AUCKLAND NORTH STAND

Walters Road, Kingsland | Gate B

ABOUT THE VENUE

The Aotearoa Room provides a blank canvas for inspiration to create the room your event desires. The full black-out facilities make this space useful for presentations or dinners.

Located directly alongside the Heartland Lounge, these rooms can be used together for pre-drinks, breakout space or expos.

Pack in is from North Stand service lift, accessible through Gate Q.

AUDIO VISUAL

The lounge is a blank canvas and can easily be supplemented to bring your event to life by our in-house suppliers Vidcom.

- Multiple screen options
- Multiple sound system options
- Options for additional lighting
- Can drape the space to a suitable size for your event
- Great space for exhibitions

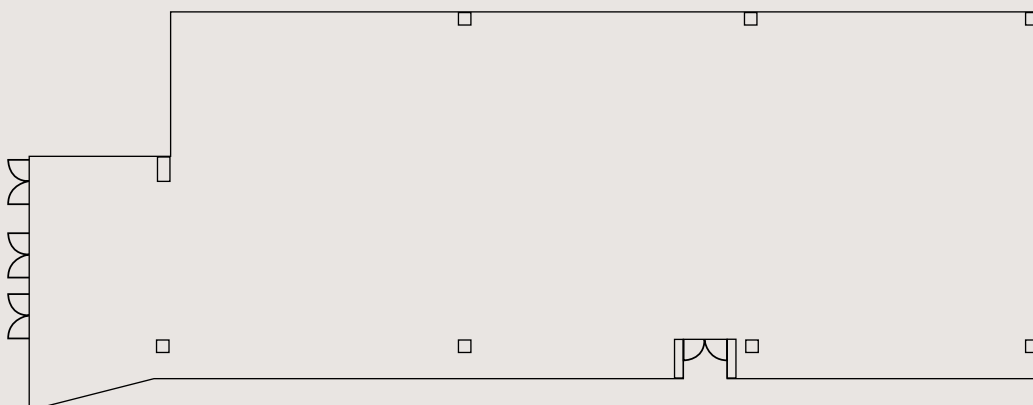

NEW ZEALAND'S NATIONAL STADIUM

BANQUET

400 guests



THEATRE STYLE

600 guests



CABARET

280 guests



COCKTAIL

750 guests



CEILING HEIGHTS

From
3,000 - 3,900 mm